

## PerformArc® Robotic Welding Cells



### PerformArc® 750S / 750SW Robotic Welding Cell



#### High Productivity, Large Work Area

This high-production system has a footprint of under 17 ft. x 10 ft. and allows for a second robot to be added, doubling throughput without requiring additional floor space. Easy-to-slide teach access doors keep the system slim and allow for tight stacking.

Extremely large work area accepts larger weldments and allows progressive fixtures to be used to eliminate the need to rotate welds into position.

The 750S and SW utilize standard

AC servo motors for high-performance indexing, load balancing and quick stopping.

#### Easy to Relocate and Set Up

Moving the 750 within your facility couldn't be easier. Our pre-engineered system with fully-welded frame allows you to simply disconnect the utilities, relocate and reconnect.

A standard platen design with bolt and dowel holes provides repeatable fixture mounting when multiple fixtures are exchanged on the same work cell.

#### ProStar™ Fume Collector Systems

Praxair provides turnkey, integrated filtration systems for all models including overhead capture hood, ductwork package and ground based dust collector.

- Custom hoods fit all sizes and platforms
- Basic duct package includes spark arresstance
- Dust collectors for all metal types including SS with HEPA after filter capabilities
- Factory pre-wired controls
- Smoke detector with fan shutdown and fire suppression system.

Top View (Standard Single Robot)

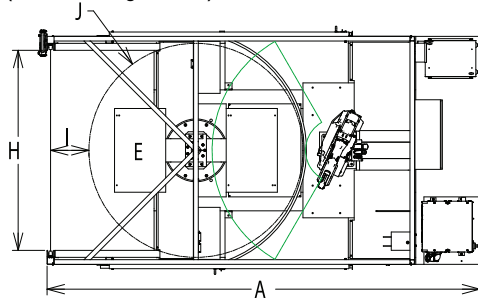

Side View (Optional Dual Robot)

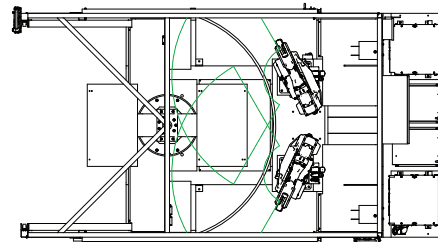

Front View

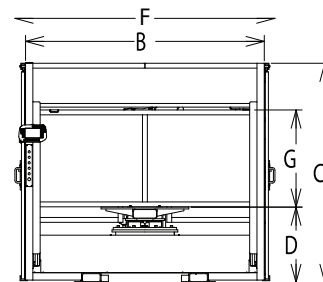

SPECIFICATIONS	PerformArc®		
		750S	750SW
FRAME LENGTH	A	186 in.	204 in.
FRAME WIDTH	B	98 in.	114 in.
FRAME HEIGHT	C	90 in.	90 in.
FIXTURE CL FROM FLOOR	D	31 in.	31 in.
OVERALL PLATEN SIZE	E	22 in. D 36 in. W	22 in. D 36 in. W
CELL WIDTH	F	107 in.	123 in.
FIXTURE MAX ROTATION HEIGHT	G	40 in.	40 in.
CELL FRONT OPENING MAX	H	86 in.	102 in.
PENETRATION DISTANCE (STOPPING CALCULATION)	I	17 in.	19 in.
ROTATION DIAMETER	J	92 in.	108 in.
SHIPPING WEIGHT		6325 lbs.	6645 lbs.

\*Note: All dimensions are approximate.

POSITIONER GENERAL TECHNICAL SPECIFICATIONS	
MODEL	Servo Positioner
MOTOR TYPE	2 kW AC Digital Servo
CONTROL TYPE	Servo Control
PAYLOAD (PER SIDE)	329 kg (725 lbs.)
PAYLOAD OFFSET (FROM POSITIONER CL)	24 in.
ROTATION TIME (180 deg. index)	t < 3.5 sec.
THROUGH HOLE (for utility pass through)	2.95 in.

### Power Source Options

Advanced MIG (GMAW)	TIG (GTAW)
Auto-Continuum™ 350A / 500A	Dynasty® 400A
TAWERS 350A / 450A	Dynasty® 800A
	BP4-300A

### STANDARD FEATURES

- 6 kg welding robot
- 64-bit controller with TFT color display teaching pendant utilizing Windows® CE
- Auto-Continuum™ Advanced MIG Welding System
- Auto-Continuum wire drive motor assembly
- Tregaskiss™ air-cooled welding torch
- Miller designed and manufactured total productivity system

### SYSTEM FEATURES

- Integrated operator interface (E-Stop, Auto Mode, Servo On, Mode Select, Table Load/Unload, Cycle Start, Collision Detect, Auto Backup)
- (2) Sliding doors for easy access to the teaching area
- TCP pointer and resident TCP check program
- Tip change monitor and maintenance program for easy torch upkeep
- Arc start retry, arc overlapping, flying arc start, password protection
- Resume function, shifting function

### Robot Options

750S		750SW	
Single	Dual Robot	Single	Dual Robot
TM1400	TM1400	TM1400	TM1400
TM1600		TM1600	TM1600
TM1800		TM1800	